



9, LYNDEAN INDUSTRIAL ESTATE, FELIXSTOWE ROAD, LONDON, SE2

COMMERCIAL PROPERTY

RENT £6666

SIZE 6600 SQFT

RATES

INTERESTED PARTIES ARE ADVISED TO MAKE THEIR OWN ENQUIRIES TO THE LOCAL AUTHORITY

VAT

NO

GUARANTOR

YES

TERMS

TO BE LET A NEW LEASE FOR A TERM TO BE AGREED

LEGAL COST

EACH PARTY TO BEAR THEIR OWN LEGAL COSTS

EPC RATING

VIEWING

PLEASE CONTACT US





**9, LYNDEAN
INDUSTRIAL ESTATE,
FELIXSTOWE ROAD,
LONDON, SE2**

VIBE WAREHOUSES

About The Property

- Commercial property available at Lyndean Industrial Estate, Felixstowe Road, London, SE2.
- Monthly rent: £6666 for a spacious 6600 sq ft area.
- Just a 4-minute walk to the nearest bus stop.
- Abby Wood Tube and National Rail station, only 4 minutes away.
- Convenient access to London City Airport within 20 minutes by tube.
- The perfect location for your business operations.
- Contact us for more information and to schedule a viewing.

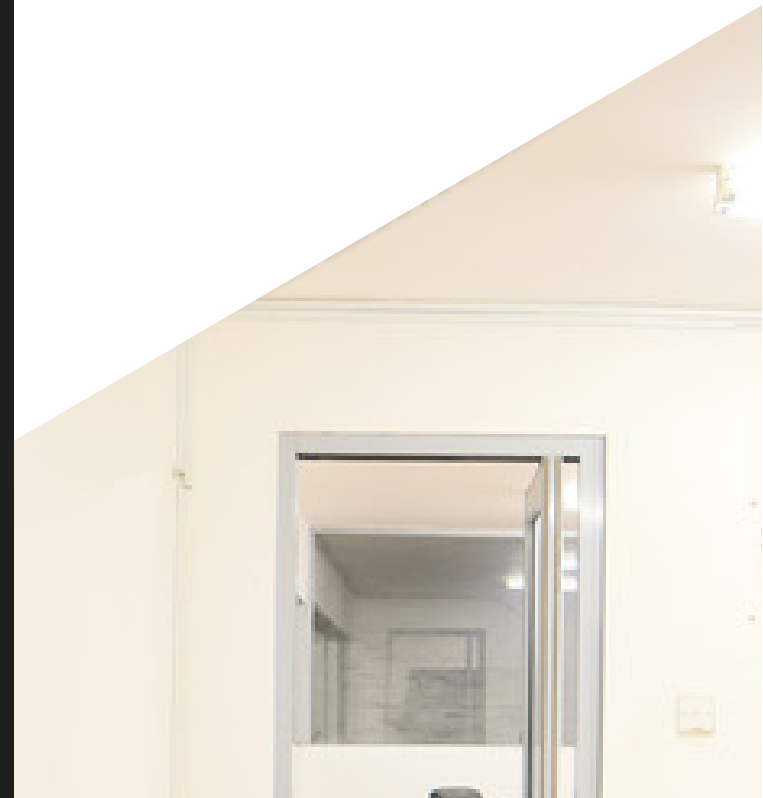

Phone

0203-935-4544

Website

www.vibewarehouses.co.uk

Address

Harvest House, London, E5 9LU

Mail

info@vibewarehouses.co.uk